

6

5

4

3

2

1

DWG. NO.

MARK	DATE	REVISION	REASON	SIGNATURE
------	------	----------	--------	-----------

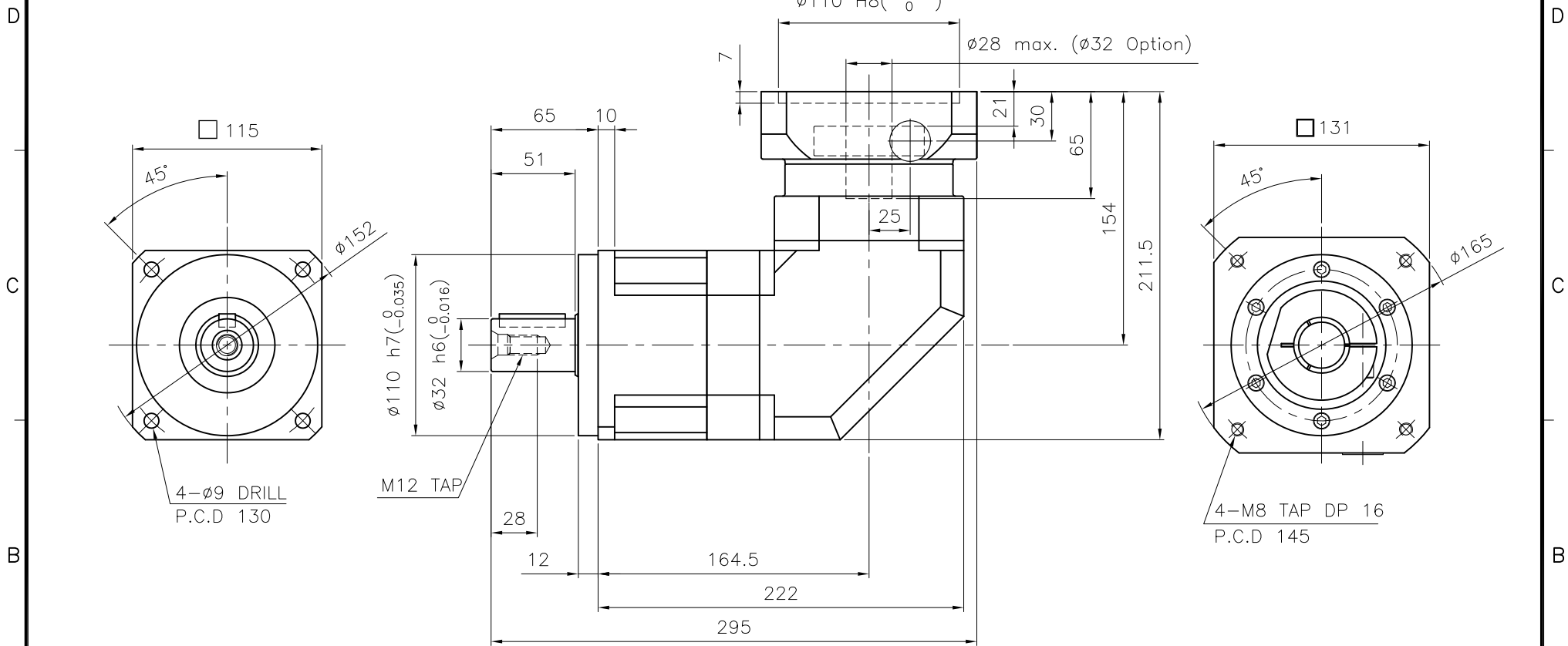

SPECIFICATION

1. Reducer Stage : 1
2. Ratio : 1/3~1/20
3. Output Shaft Shape : Non-Key Type (S1)  
Key Type (S2)
4. Backlash
  - 4-1) Precision Backlash P1( $\leq 4$  arcmin)
  - 4-2) Low Backlash P2( $\leq 6$  arcmin)
  - 4-3) Standard Backlash P3( $\leq 10$  arcmin)
5. Input Shaft Dia. :  $\phi 28$  max. ( $\phi 32$  option)  
In case that motor shaft Dia. is smaller than  $\phi 28$   
Bushing is supplied

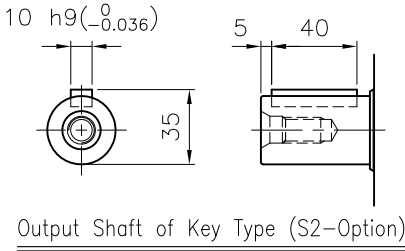

Output Shaft of Key Type (S2-Option)

GENERAL TOLERANCE (mm)	SURFACE ROUGHNESS	- NPR - 115 $\phi 165 \times 295 \times 211.5$		-	1			
0.5~3 ±0.1	0.4	NO.	DESCRIPTIONS	SIZE	MAT'L	Q'TY	WEIGHT (kgf)	REMARKS
3~6 ±0.1	1.25	CUSTOMER			SCALE	1 / 2.5	PROJECTION	
6~30 ±0.2	2.5	TITLE		NPR-115(1/3~1/20)	DWG.NO.	NPR11500A1-130A	REV. NO.	
30~120 ±0.3	5	DRAWN		S.R.JEON	CHECKED		APPROVED	0
120~400 ±0.5	12.5	DRAWN		S.R.JEON	CHECKED		APPROVED	
400~1000 ±0.8	25	DRAWN		S.R.JEON	CHECKED		APPROVED	
1000~2000 ±1.2	50	DRAWN		S.R.JEON	CHECKED		APPROVED	
2000~4000 ±2	100	DRAWN		S.R.JEON	CHECKED		APPROVED	



6

5

4

3

2

1