

6

5

4

3

2

1

DWG. NO.

MARK	DATE	REVISION	REASON	SIGNATURE

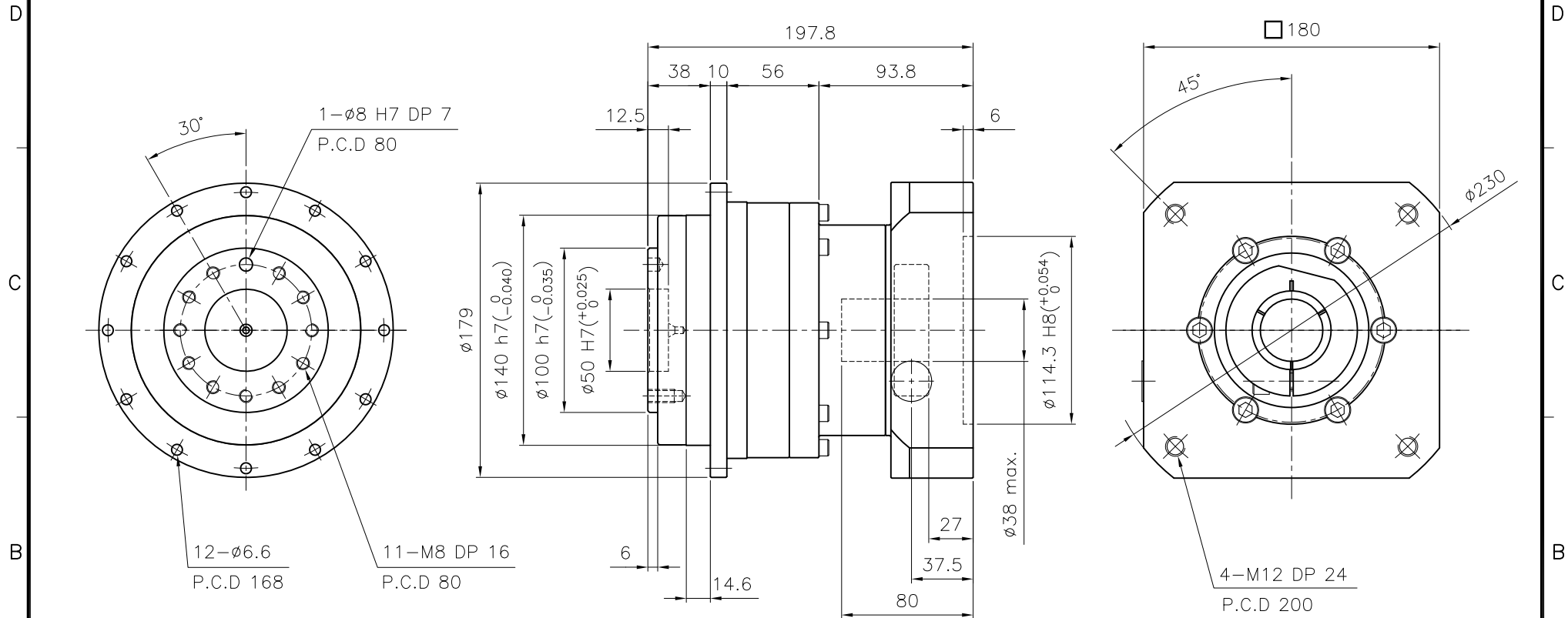

SPECIFICATION

- Reducer Stage : 1
- Ratio : 1/4 , 1/5 , 1/7 , 1/10
- Backlash
 - Precision Backlash P1(≤ 3 arcmin)
 - Low Backlash P2(≤ 5 arcmin)
 - Standard Backlash P3(≤ 8 arcmin)
- Input Shaft Dia. : $\phi 38$ max.
In case that motor shaft Dia. is smaller than $\phi 38$
Bushing is supplied

GENERAL TOLERANCE (mm)	SURFACE ROUGHNESS	FINISH MARK	NF-140		$\phi 230 \times 197.8$		-		1		-	
0.5~3	Ra	Rmax	NO.	DESCRIPTIONS	SIZE	MAT'L	Q'TY	WEIGHT (kgf)	REMARKS			
3~6	± 0.1	\sim	CUSTOMER	STANDARD	SCALE	1 / 2.5	PROJECTION		A			
6~30	± 0.2	\sim	TITLE	NF - 140(1/4~1/10)	DWG.NO.	NF14000A1-180A	REV. NO.	0				
30~120	± 0.3	\sim	DRAWN	S.R.JEON	CHECKED		APPROVED					
120~400	± 0.5	\sim	2018.10.01									
400~1000	± 0.8	\sim										
1000~2000	± 1.2	\sim										
2000~4000	± 2	\sim										